

DG247

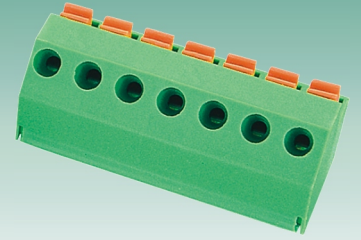

DG390



DG237

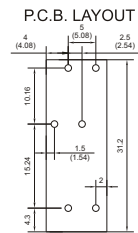
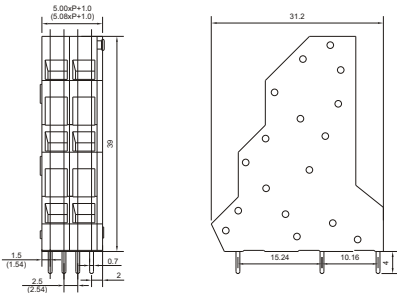

Pitch:5.0mm,5.08mm

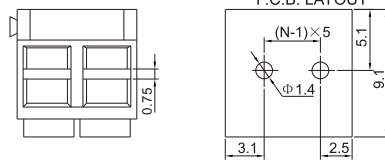
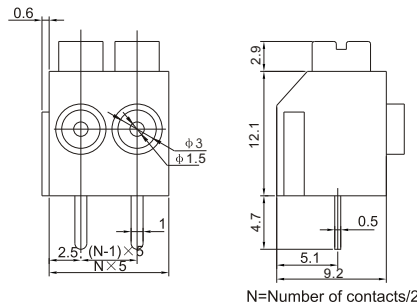

Pitch:5mm

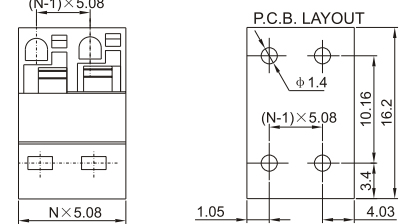
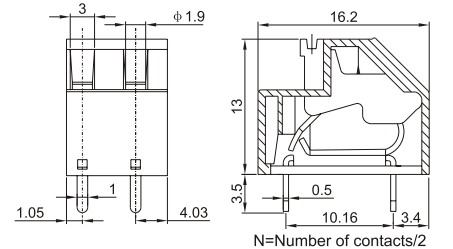

Pitch:5.08mm

● 材质及电镀

焊针 : 黄铜, 镀锡
塑件 : PA66, UL94V-0

● 电气性能

额定电压 : 300V
额定电流 : 10A
接触电阻 : 20mΩ
绝缘电阻 : 5000MΩ/1000V
耐电压 : AC1500V/1Min
使用线径 : 28-12AWG 2.5mm²

● 机械性能

温度范围 : -40°C~+120°C
瞬时温度 : +250°C 5秒
剥线长度 : 6-7mm

● Material

Pin header : Brass, Tin plated
Housing : PA66, UL94V-0

● Electrical

Rated voltage : 300V
Rated current : 10A
Contact resistance : 20mΩ
Insulation resistance: 5000MΩ/1000V
Withstanding voltage: AC1500V/1Min
Wire range :

● Mechanical

Temp.Range : -40°C~+120°C
MAX Soldering : +250°C, for 5 Sec.
Strip length : 6-7mm

● 材质及电镀

触点材料: 不锈钢带
焊针 : 黄铜, 镀锡
塑件 : PBT, UL94V-0

● 电气性能

额定电压 : 300V
额定电流 : 8A
接触电阻 : 20mΩ
绝缘电阻 : 5000MΩ/1000V
耐电压 : AC1500V/1Min
使用线径 : 22-18AWG 1mm²

● 机械性能

温度范围 : -30°C~+120°C
瞬时温度 : +250°C 5秒
剥线长度 : 7-7.5mm

● Material

Contact : Stainless strip steel
Pin header : Brass, Tin plated
Housing : PBT, UL94V-0

● Electrical

Rated voltage : 300V
Rated current : 8A
Contact resistance : 20mΩ
Insulation resistance: 5000MΩ/1000V
Withstanding voltage: AC1500V/1Min
Wire range : 22-18AWG 1mm²

● Mechanical

Temp.Range : -30°C~+120°C
MAX Soldering : +250°C, for 5 Sec.
Strip length : 7-7.5mm

● 材质及电镀

焊针 : 黄铜, 镀锡
塑件 : PA66, UL94V-0

● 电气性能

额定电压 : 300V
额定电流 : 12A
接触电阻 : 20mΩ
绝缘电阻 : 5000MΩ/1000V
耐电压 : AC1500V/1Min
使用线径 : 22-16AWG 1.5mm²

● 机械性能

温度范围 : -40°C~+105°C
瞬时温度 : +250°C 5秒
剥线长度 : 8-9mm

● Material

Pin header : Brass, Tin plated
Housing : PA66, UL94V-0

● Electrical

Rated voltage : 300V
Rated current : 12A
Contact resistance : 20mΩ
Insulation resistance: 5000MΩ/1000V
Withstanding voltage: AC1500V/1Min
Wire range : 22-16AWG 1.5mm²

● Mechanical

Temp.Range : -40°C~+105°C
MAX Soldering : +250°C, for 5 Sec.
Strip length : 8-9mm